

Stepping Motors

M25SP-6NK

FEATURES

1. Compact size and high-output torque.
2. Superior running quietness and stability.

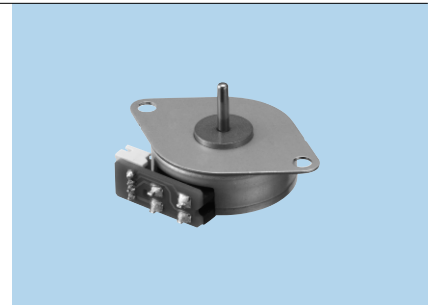

USES

Multifunction machines, scanners, etc.

SPECIFICATIONS

Item	M25SP-6NK
Rated Voltage	DC 24V
Working Voltage	DC 21.6~26.4V
Rated Current/Phase	250mA (PEAK)
Coil DC Resistance	65Ω/phase±7%
Step Angle	7.5°/step
Drive Method	Constant Current
Excitation Method	2-2 Phase excitation (Bipolar driving)
Insulation Class	Class E insulation
Holding Torque	16.5mN·m
Pull-out Torque	13.3mN·m/400pps
Pull-in Torque	13.3mN·m/400pps
Max. Pull-out Pulse Rate	2,050pps
Max. Pull-in Pulse Rate	1,350pps

CHARACTERISTICS

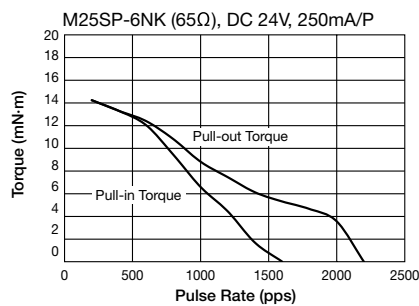

DIMENSIONS

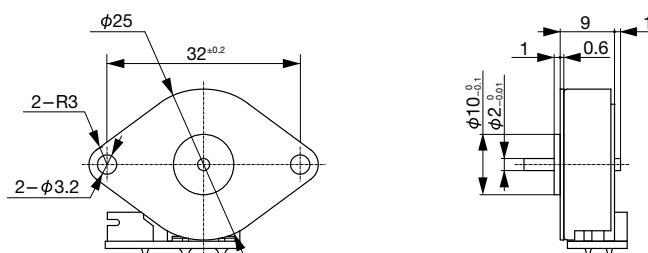

Unit : mm
General tolerance : ±0.5

• Any products mentioned in this catalog are subject to any modification in their appearance and others for improvements without prior notification.
• The details listed here are not a guarantee of the individual products at the time of ordering. When using the products, you will be asked to check their specifications.