

M10SP-2N

特長 / FEATURES

1. 小型・軽量・高出力トルク。
 2. 優れた走行静粛性。
-
1. Compact size, lightweight and high-output torque.
 2. Superior running quietness.

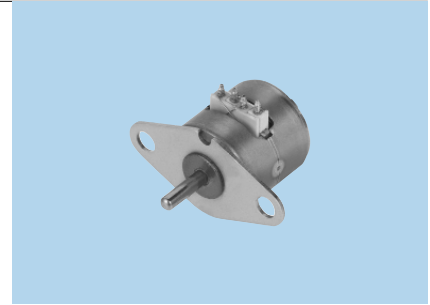

用途 / USES

Scanners, mini-printers, multifunction machines.

仕様 / SPECIFICATIONS

| 項目 / Item | M10SP-2N |
|-------------------------------------|--|
| 定格電圧 Rated Voltage | DC 5V |
| 使用電圧範囲 Working Voltage | DC 4~6V |
| 定格電流/相 Rated Current/Phase | 0.125mA (Peak) |
| 巻線抵抗 Coil DC Resistance | 10Ω/phase±10% |
| ステップ角度 Step Angle | 18° /step |
| 駆動方式 Drive Method | Constant Current |
| 励磁方式 Excitation Method | 2-2 Phase excitation (Bipolar driving) |
| 絶縁階級 Insulation Class | Class E insulation |
| プルアウト・トルク Pull-out Torque | 0.71mN·m/400pps |
| プルイン・トルク Pull-in Torque | 0.68mN·m/400pps |
| 最大応答周波数 Max. Pull-out Pulse Rate | 4,100pps |
| 最大自起動周波数 Max. Pull-in Pulse Rate | 880pps |

特性図 / CHARACTERISTICS

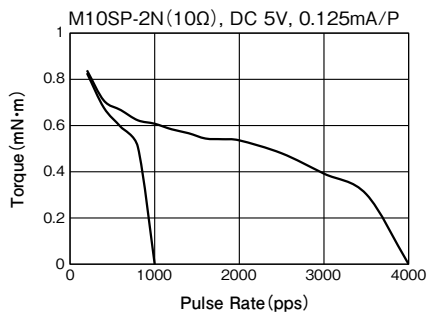

外形図 / DIMENSIONS

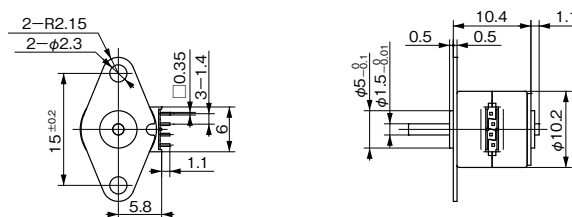

Unit : mm
General tolerance : ±0.5