

# Packing

## Embossed Taping

### 1. List of reel dimensions for taping and number of devices per unit

Units : mm

Package type		A	N	W	Standard number stored
SOP	7A	254	100	16.4	1,000/reel
	8A	254	100	16.4	1,000/reel
	8B	254	100	16.4	1,000/reel
	8C	330	80	13.5	2,000/reel
	8D	330	80	13.5	2,000/reel
	8E	330	80	13.5	2,000/reel
	10A	330	80	13.5	2,000/reel
	14A	254	100	16.4	1,000/reel
	14B	330	80	17.5	2,000/reel
	16A	254	100	16.4	1,000/reel
	16B	330	80	17.5	2,000/reel
	18A	330	80	25.5	2,000/reel
	20B	330	80	25.5	2,000/reel
	22A	330	80	25.5	2,000/reel
24A	330	80	25.5	2,000/reel	
28B	330	100	25.5	2,000/reel	
SSOP	16A	330	80	13.5	2,000/reel
	20A	330	80	17.5	2,000/reel
	24A	330	80	17.5	2,000/reel
VSOP	8A	330	80	13.5	2,000/reel
	8B	180	60	13.0	3,000/reel
	8C	180	60	13.0	3,000/reel
	8D	180	60	13.0	3,000/reel
	16A	330	80	13.5	2,000/reel
	24A	330	80	17.5	2,000/reel
TSOP	16A	254	100	16.4	2,000/reel
	20A	254	100	16.4	2,000/reel
	20F	330	100	12.5	2,500/reel
	24A	254	100	16.4	2,000/reel
MMP	3A	180	60	13.0	1,000/reel
	3B	180	60	13.0	1,000/reel
SOT-25	(5)A	180	60	9.0	3,000/reel
SOT-26	(6)A	180	60	9.0	3,000/reel
SC-82AB	(4)A	180	60	9.0	3,000/reel
SSON	4B	180	60	9.0	3,000/reel
	8C	178	72	8.4	3,000/reel
PLP	4B	180	60	9.0	5,000/reel
	6A	180	60	9.0	5,000/reel
	8A	180	60	9.0	5,000/reel
	10A	180	60	9.0	5,000/reel
WLCSP	20A	178	60	8.4	3,000/reel
	25A	178	60	8.4	3,000/reel

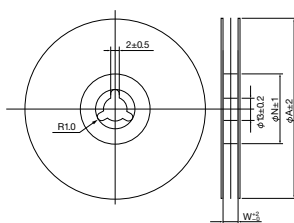

# Packing

## 2. List of embossed carrier tape dimensions

Units : mm

Package type	A0	B0	W	F	P1	T	T2	D1	
SOP	7A	8.80	6.40	16.0	7.5	12.0	0.30	2.75	1.55
	8A	8.80	6.40	16.0	7.5	12.0	0.30	2.75	1.55
	8B	7.50	5.40	16.0	7.5	12.0	0.30	2.75	1.55
	8C	6.70	5.50	12.0	5.5	8.0	0.30	2.51	2.00
	8D	6.65	5.40	12.0	5.5	8.0	0.30	2.20	1.55
	8E	6.70	5.50	12.0	5.5	8.0	0.30	2.51	2.00
	10A	6.65	5.40	12.0	5.5	8.0	0.30	2.20	1.55
	14A	8.50	10.60	16.0	7.5	12.0	0.30	2.75	1.55
	14B	6.60	9.55	16.0	7.5	8.0	0.30	2.46	2.05
	16A	8.50	10.60	16.0	7.5	12.0	0.30	2.75	1.55
	16B	6.70	10.50	16.0	7.5	8.0	0.30	2.46	2.05
	18A	8.40	12.00	24.0	11.5	12.0	0.30	2.86	2.05
	20B	8.30	13.20	24.0	11.5	12.0	0.30	2.66	2.05
	22A	8.40	14.50	24.0	11.5	12.0	0.30	2.86	2.05
24A	8.50	15.60	24.0	11.5	12.0	0.30	3.01	2.05	
28B	10.60	18.10	24.0	11.5	12.0	0.30	2.60	2.05	
SSOP	16A	6.85	7.40	12.0	5.5	8.0	0.30	2.51	1.55
	20A	8.40	9.30	16.0	7.5	12.0	0.30	2.86	1.55
	24A	8.30	10.50	16.0	7.5	12.0	0.30	2.86	2.05
VSOP	8A	6.90	3.70	12.0	5.5	8.0	0.30	2.16	1.55
	8B	3.05	4.40	12.0	5.5	4.0	0.30	1.60	1.05
	8C	3.15	4.25	12.0	5.5	4.0	0.30	1.60	1.10
	8D	3.15	4.25	12.0	5.5	4.0	0.30	1.60	1.10
	16A	6.90	5.60	12.0	5.5	8.0	0.30	2.26	1.55
	24A	8.15	8.40	16.0	7.5	12.0	0.30	2.36	1.55
TSOP	16A	6.90	5.35	16.0	7.5	8.0	0.30	2.15	1.55
	20A	6.90	6.95	16.0	7.5	8.0	0.30	2.15	1.55
	20F	6.80	6.90	12.0	5.5	8.0	0.30	2.00	1.60
	24A	6.90	6.95	16.0	7.5	8.0	0.30	2.15	1.55
MMP	3A	4.90	5.70	12.0	5.5	8.0	0.30	2.55	1.55
	3B	5.00	5.70	12.0	5.5	8.0	0.30	2.45	1.55
SOT-25	(5)A	3.30	3.20	8.0	3.5	4.0	0.25	1.75	1.00
SOT-26	(6)A	3.30	3.20	8.0	3.5	4.0	0.25	1.75	1.00
SC-82AB	(4)A	2.20	2.60	8.0	3.5	4.0	0.20	1.30	1.05
SSON	4B	1.25	1.55	8.0	3.5	4.0	0.20	0.70	0.50
	8C	3.35	3.35	8.0	3.5	4.0	0.20	1.45	1.00
PLP	4B	1.45	1.80	8.0	3.5	4.0	0.20	0.75	0.50
	6A	3.00	2.80	8.0	3.5	4.0	0.20	0.75	1.50
	8A	3.00	2.80	8.0	3.5	4.0	0.20	0.75	1.50
	10A	3.00	2.80	8.0	3.5	4.0	0.20	0.75	1.50
WLCSP	20A	2.19	2.19	8.0	3.5	4.0	0.25	1.00	0.50
	25A	2.19	2.19	8.0	3.5	4.0	0.25	1.00	0.50

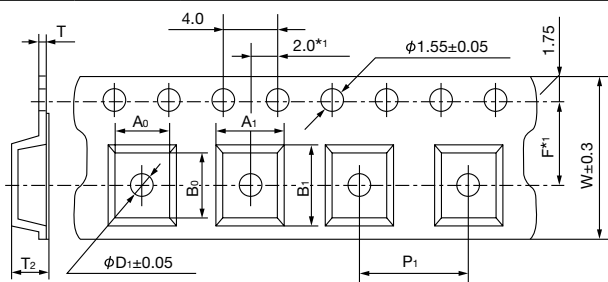

→ Direction in which tape is drawn out  
 \*1: (when W is 16 or greater, ±0.1; otherwise, ±0.05)  
 When not specified otherwise, tolerances are ±0.1

A0, B0: Dimensions of square depressions in the base plane  
 A1, B1: Dimensions of square depressions at the opening  
 (reference values)