

Self Return Slide Switches SSA Series

FEATURES

- 1-pole, 3-contacts self return slide switch.
- Suitable for SMT reflow soldering.
- Providing 6 kinds of operations and tactile feelings by unique combination of slider and cover.
- Vertical/horizontal operation knobs are available.

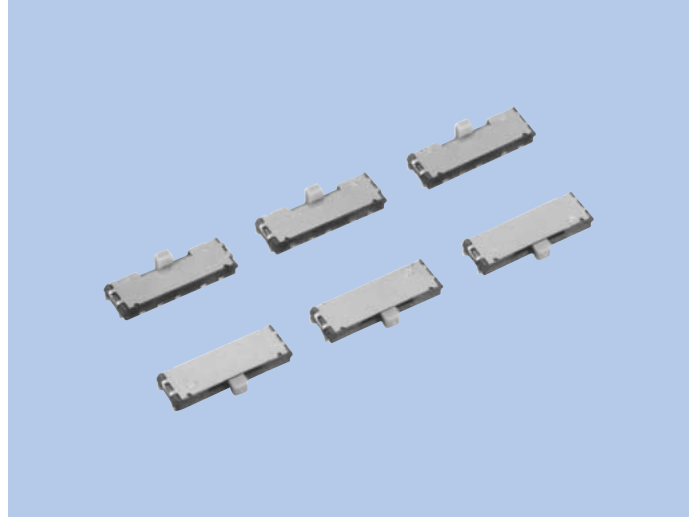

APPLICATIONS

- For portable audios, remote controllers, DSC, video players, mobile phones, PDAs, etc.
- For power switches, hold switches, mode select switches.
- For zoom function in cameras.

MODEL NAME CODE

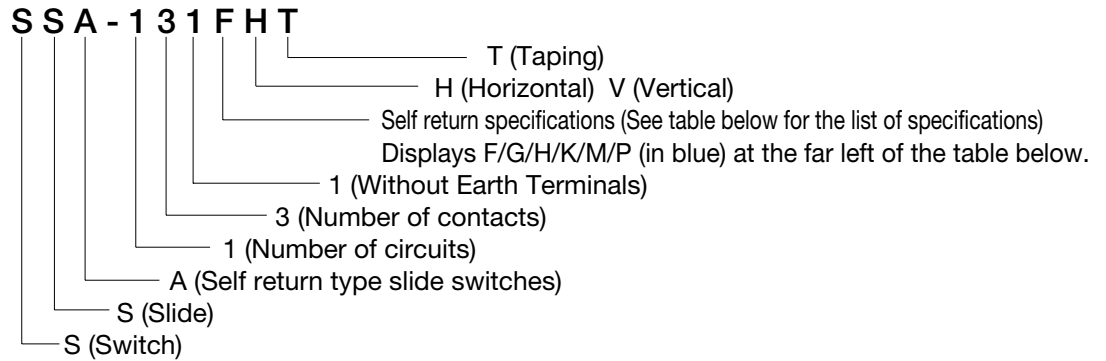

Self return specifications

	Side A: a ↔ b		Side B: b ↔ c	
	Self Return	Detent	Self Return	Detent
F	○		○	
G	○			○
H	○			
K		○	○	
M			○	
P		○		○

SPECIFICATIONS

Electrical Characteristics	Rating	0.3A, 4V DC
	Contact Resistance	1Ω or less
	Insulation Resistance	10MΩ or more
	Withstand Voltage	1 minute at 100V AC
Mechanical Characteristics	Operating Force	Self return section: 1.2±1.0N Click section: 1.5±1.0N
	Life	10,000cycles

TYPE

Model Name Code	Order Number	No. of Poles	No. of Contacts	Travel (mm)	Knob Direction	Pcs/Reel
SSA-131FHT (Typical)	R66 6804	1	3	1.5	Horizontal	5,000
SSA-131FVT (Typical)	R66 6792	1	3	1.5	Vertical	4,000

DIMENSIONS

Horizontal

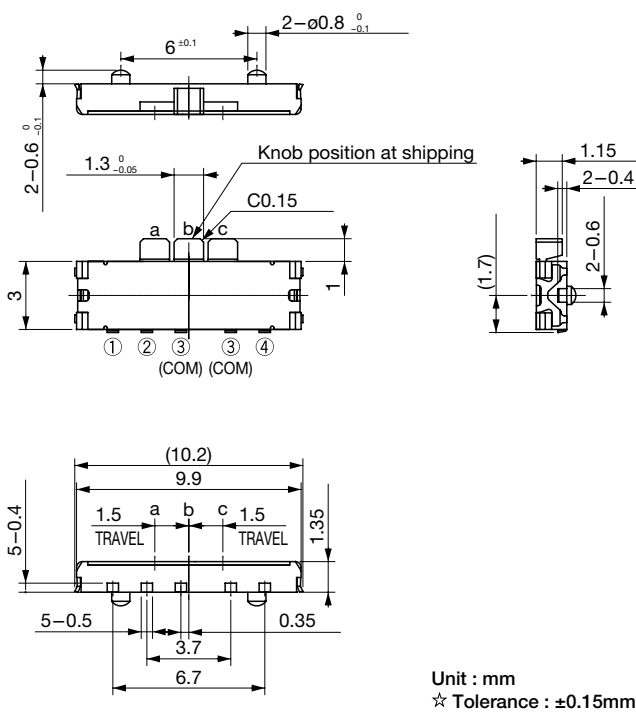

Vertical

