

Stepping Motors

M7LS-1N

OUTLINE

This model was developed with high feed precision as its main characteristic, and gives high torque and low detent torque in a unique case structure (patent pending), with external diameter of 7.2mm and thickness of 5.1mm.

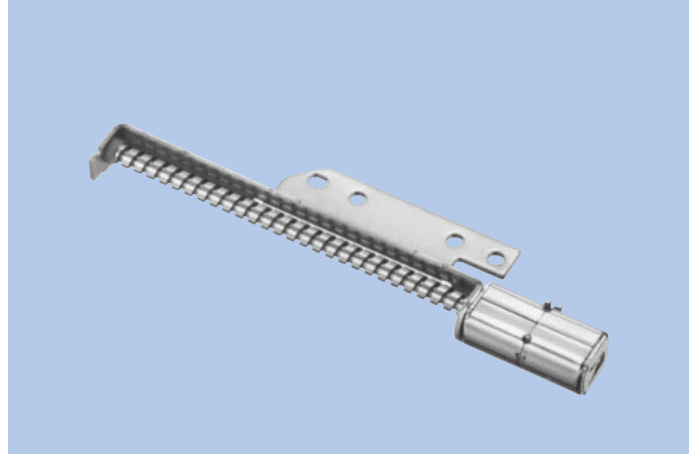

FEATURES

1. Small size, high output.
2. Low detent
3. High linearity, high feed precision
4. Step angle 7.5°

USES

9.5mm slim drives and others

SPECIFICATIONS

Items	M7LS-1N
Rated Voltage	4V
Working Voltage	3~8V
Rated Current	260mA
No. of Phase	2Phase
Coil DC Resistance	14.5Ω
Excitation Method	2-2 Phase excitation (Bipolar driving)
Insulation Class	Class E insulation
Holding Torque	0.686mN·m
Pull-out Torque	0.509mN·m/400pps
Pull-in Torque	0.435mN·m/400pps
Max. Pull-out Pulse Rate	4420pps
Max. Pull-in Pulse Rate	1020pps

CHARACTERISTICS

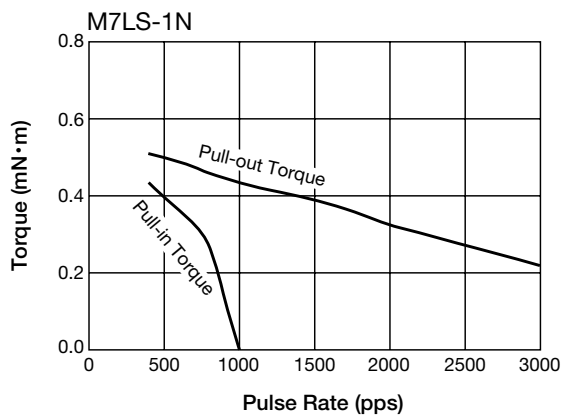

DIMENSIONS

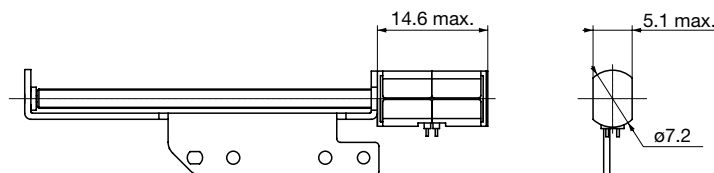

Unit : mm, General tolerance : ±0.5