

Stepping Motors

M42SP-12K

OUTLINE

M42SP-12K realizes a high responsiveness, with holding torque of 43.0mN·m, pull-out torque of 26.7mN·m/800pps and pull-in torque of 33.1mN·m/200pps(DC12V).

It also realizes superior running noiselessness, and is ideal for use in the small electronic equipment of the future.



FEATURES

1. High response · High output torque.
2. Superior running quietness and stability.
3. Step angle: 7.5°/step.
4. Excellent responsiveness acquired.

USES

Printers, multifunction machines, copy machines, FAX, and such.

SPECIFICATIONS

Items	M42SP-12K	
Rated Voltage	DC 12V	DC 24V
Working Voltage	DC 10.8~13.2V	DC 21.6~26.4V
Rated Current/Phase	600mA	600mA
No. of Phase	2 Phase (PEAK)	2 Phase (PEAK)
Coil DC Resistance	5Ω/phase±7%	5Ω/phase±7%
Step Angle	7.5°/step	7.5°/step
Excitation Method	2-2 Phase excitation (Bipolar chopping driving)	
Insulation Class	Class E insulation	Class E insulation
Holding Torque	43.0mN·m	43.0mN·m
Pull-out Torque	26.7mN·m/800pps	26.5mN·m/2000pps
Pull-in Torque	33.1mN·m/200pps	34.0mN·m/200pps
Max. Pull-out Pulse Rate	1300pps	2900pps
Max. Pull-in Pulse Rate	510pps	490pps

CHARACTERISTICS

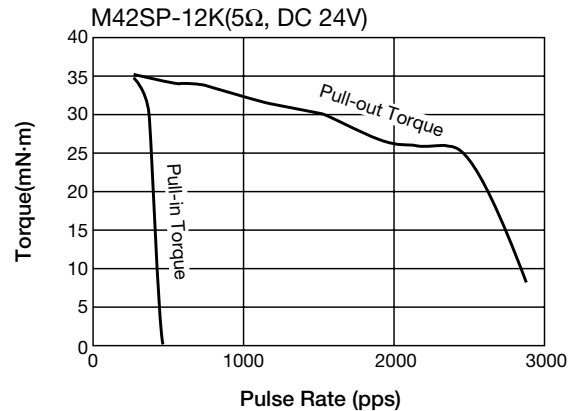
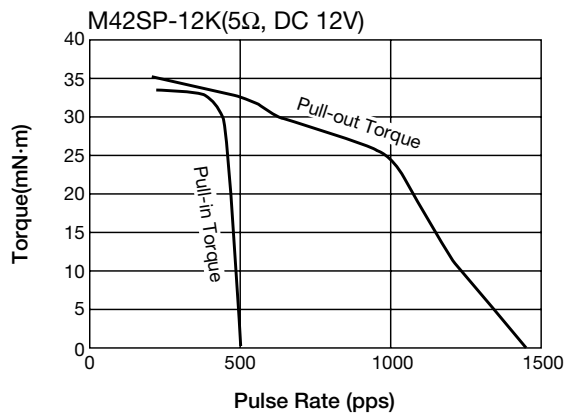

DIMENSIONS

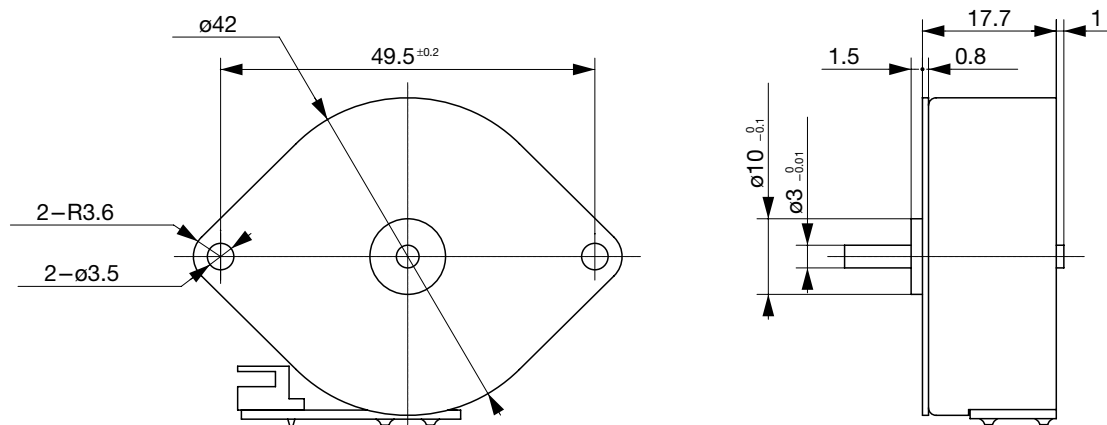

Unit : mm, General tolerance : ±0.5