

Stepping Motors

M15SP-2N

OUTLINE

A dual-type stepping motor of external diameter $\phi 15$ mm and length 19.7 mm.

This model has been designed to output a significant torque while retaining the small size of previous models.

The step angle is the same 18°step as on previous models.



FEATURES

A structure including 2 coupled motors enables high-output torque.

USES

Small printer paper feeder, projector aperture etc.

SPECIFICATIONS

Item	M15SP-2N
Rated Voltage	DC24V±5%
Working Current/Phase	150mA/Phase
No.of Phases	2Phase
Coil DC Resistance	49Ω/Phase±7%
Step Angle	18°/Step
Excitation Method	2-2 Phase excitation (Baipolar driving)
Insulation Class	Class E Insulation
Holding Torque	9.5mN·m
Pull-out Torque	4.6mN·m/600pps
Pull-in Torque	4.1mN·m/600pps
Max Pull-out Pulse Rate	1500pps
Max Pull-in Pulse Rate	2900pps

CHARACTERISTICS

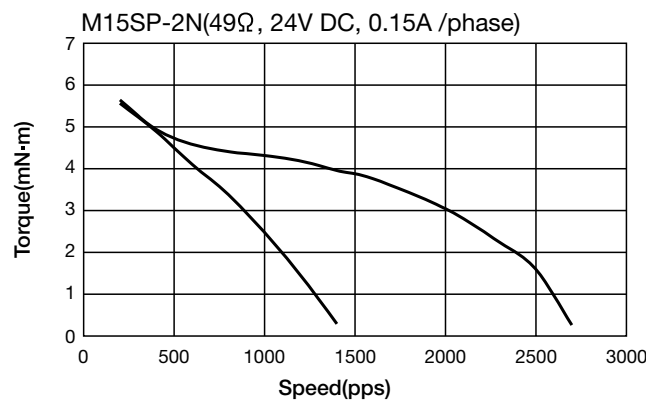

DIMENSIONS

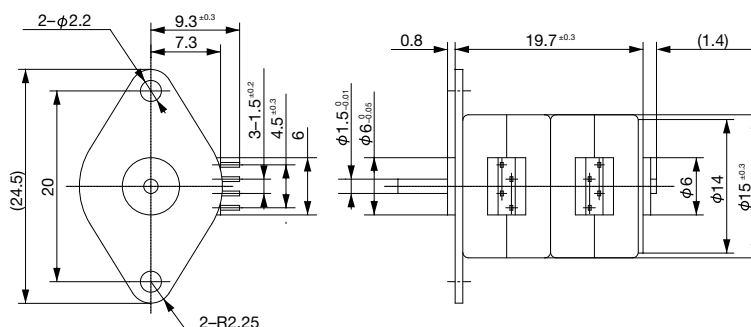

Unit : mm, General tolerance : ±0.5