

Mini Circular Connectors IRM-A78 Series

FEATURES

Angle-type minicircular connectors feature a simplified locking mechanism. This allows them to engage with dip-type CRM-A18 substrates and IRM-A20 relaying cable Ass'y.



HOW TO ORDER

A78-□□□-□□□□□□

1 2 3

- 1 Series No.
- 2 No. of contacts (005 : 5pins, 006 : 6pins, 008 : 8pins)
- 3 Product Specifications (1894C : 5pins, 1894D : 6pins, 1894A : 8pins)

SPECIFICATIONS

ELECTRICAL CHARACTERISTICS

Rated Voltage	30V DC
Rated Current	1A DC
Withstanding Voltage	250V AC (rms) 1minute
Insulation Resistance	50MΩ min. (at 250V DC)
Contact Resistance	30mΩ max.

MECHANICAL CHARACTERISTICS

Life (Matching Cycle)	1,000 times
Total Insertion Force	49N (5kgf) max.
Total Withdrawal Force	2~49N (0.2~5kgf)
Using Temperature Range	-20~+80°C

MATERIAL & FINISH

Component Parts	Material	Finish
Cover	PBT resin	—
Top Cover	PBT resin	—
Shielded Case	Copper Alloy	Nickel plating
Contact	Copper Alloy	Tin reflow plating
Lock	Copper Alloy	Nickel plating
Housing	PBT resin	—
Cord Clamper	Aluminum	—
Slider	PBT resin	—

DIMENSIONS

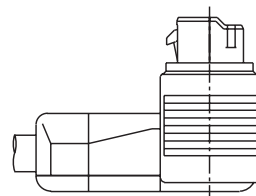
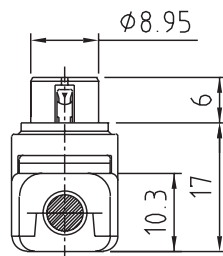
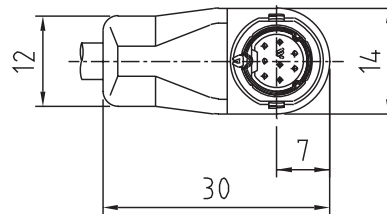

Unit : mm